

ASSEMBLY INSTRUCTION

OKBeeSAFE04T

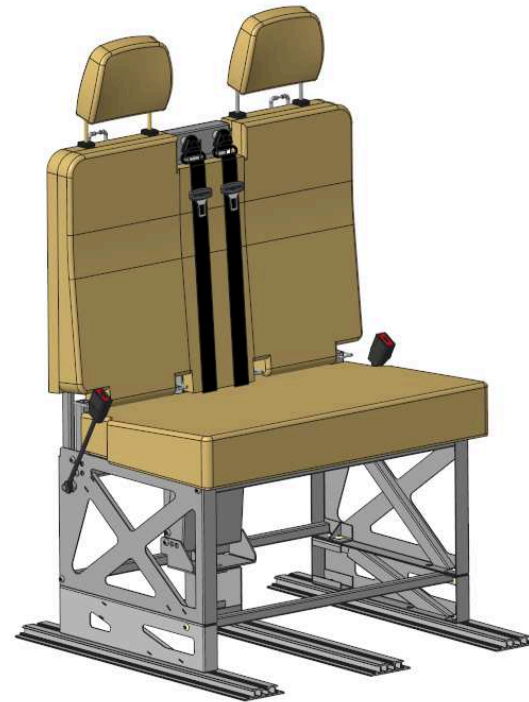

STEP 1

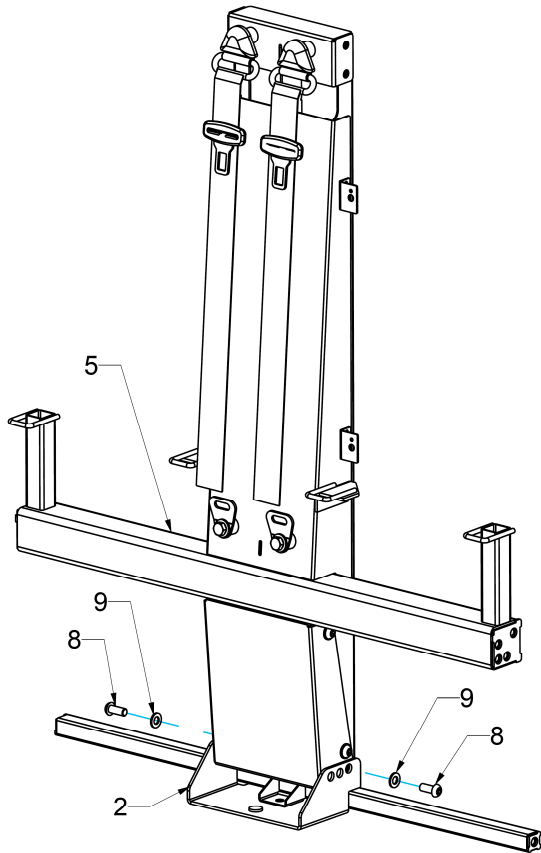

Tightening torque for screws: 65 Nm

STEP 2

Drill a new $\varnothing 20$ holes in the aluminium rails, according to the new position of the positioning bolts.

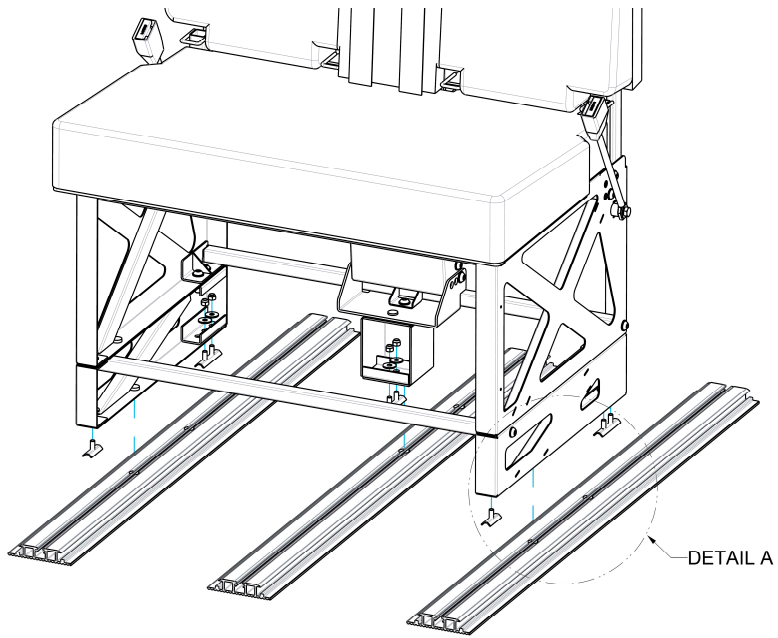

DETAIL A

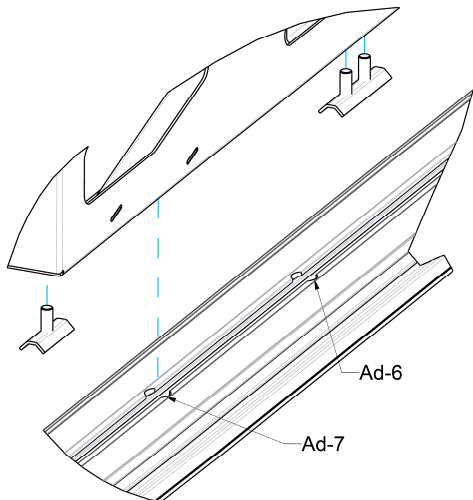

Ad-6. Hole for locking pin in standard position
Ad-7. Hole for locking pin drilled in customized position

STEP 2

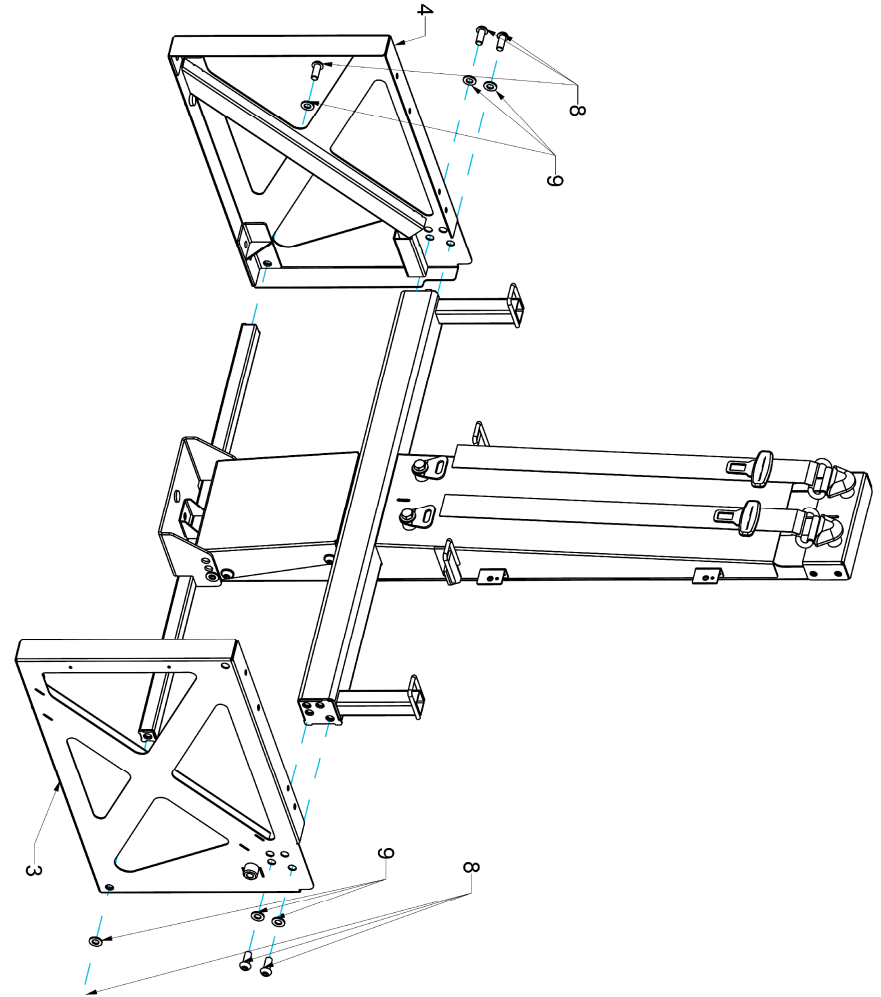

Tightening torque for screws: 65 Nm

NON STANDARD POSITIONING IN THE ALUMINIUM RAILS

STEP 3

Adjust one of 3 possible backrest angles by choosing fixation holes

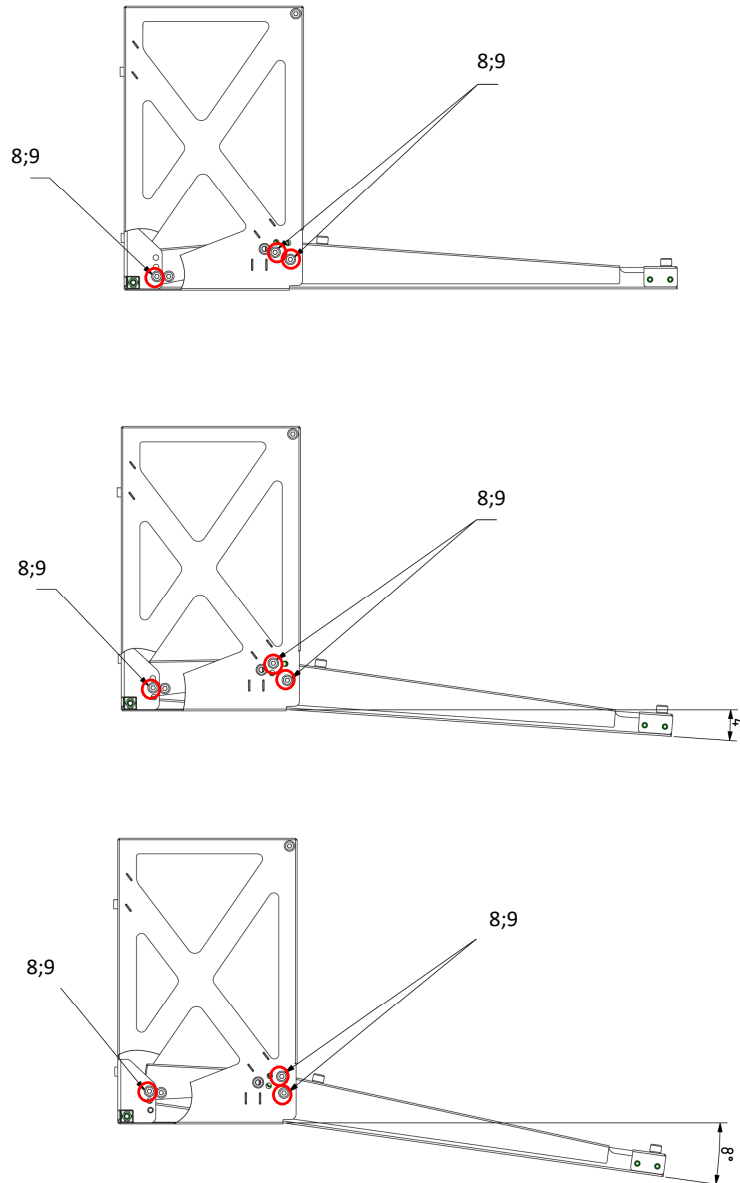

STEP 1

Keep both of below positioning conditions:

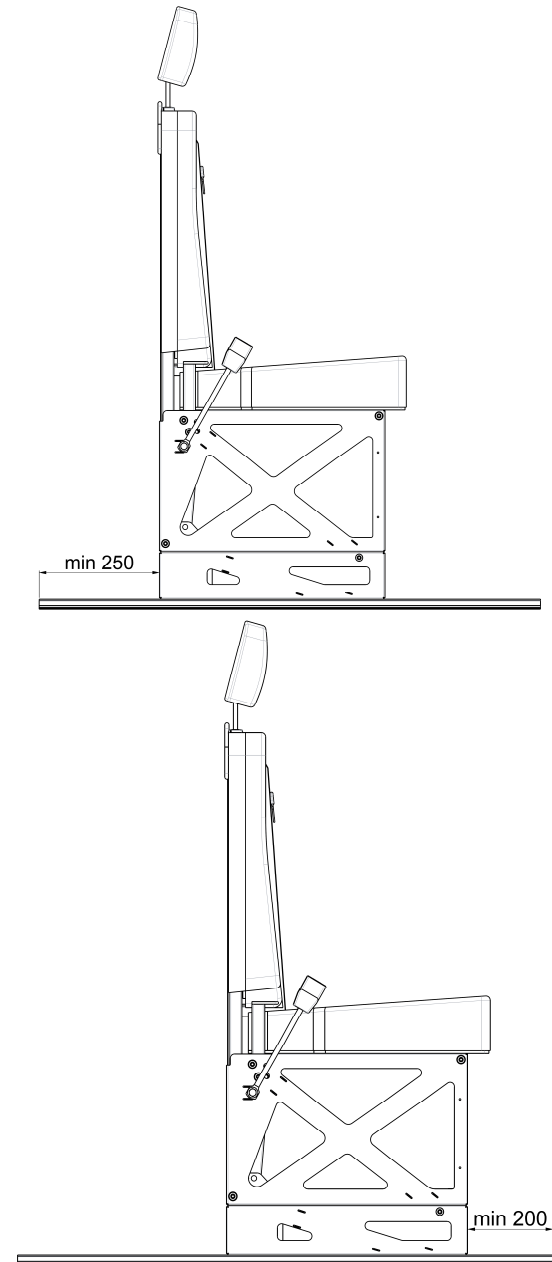

WITH HEIGHT ADJUSTER

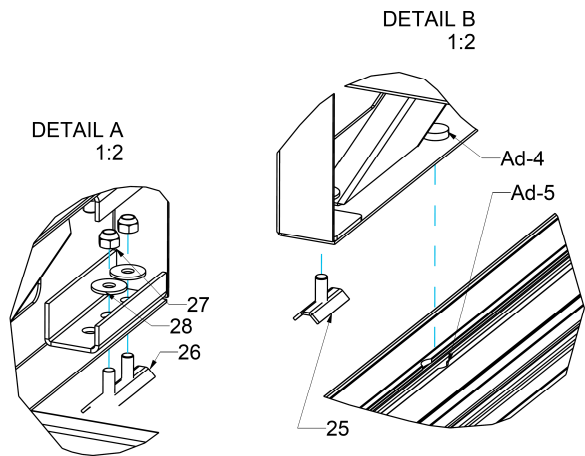
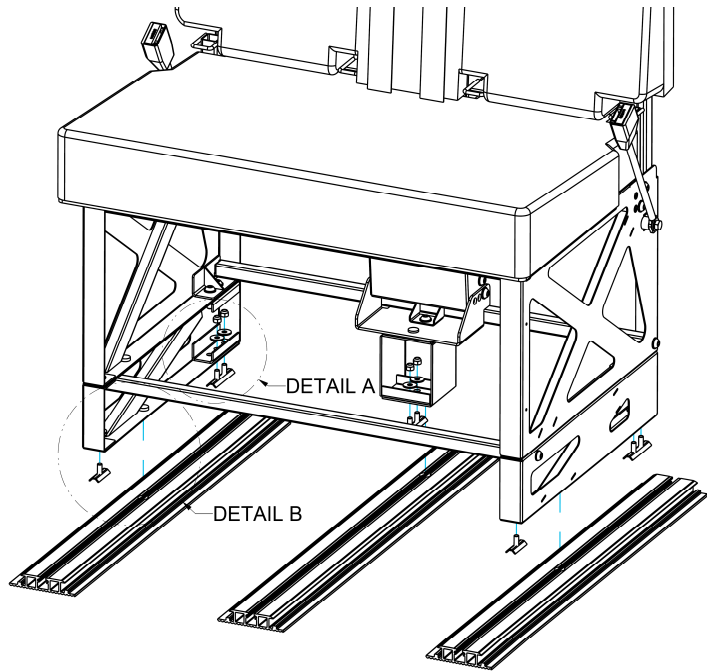

Tightening torque for screws: 27 Nm

Ad-4. Locking pin

Ad-5. Hole for locking pin

STEP 4

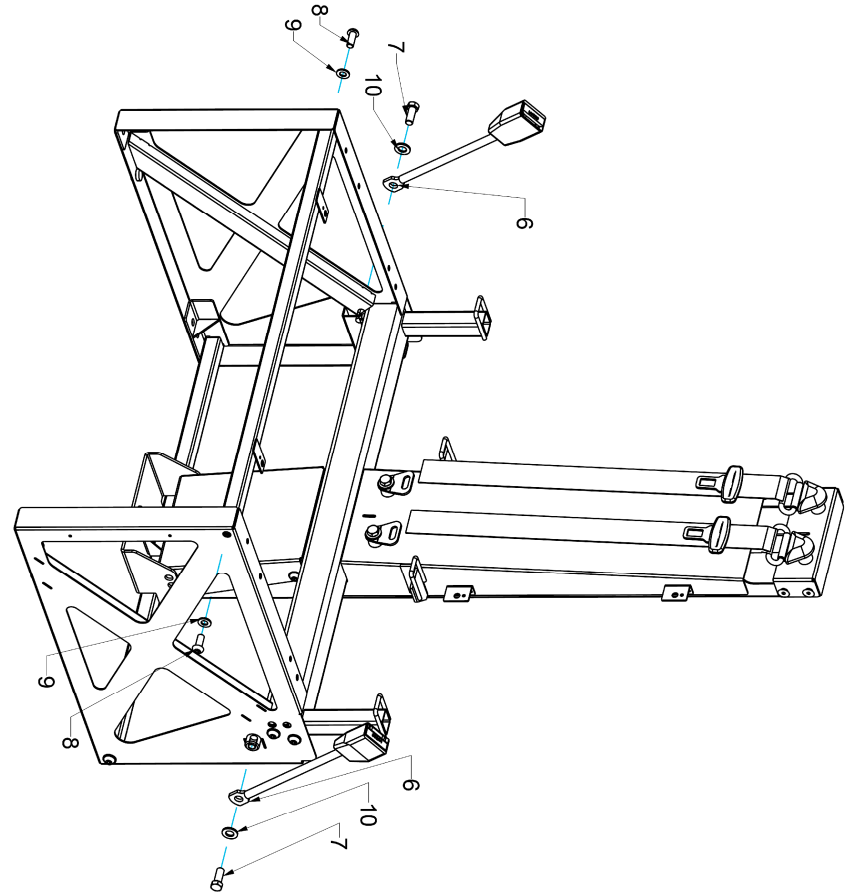

Tightening torque for screws: 65 Nm

ASSEMBLY OF OPTIONAL EQUIPMENT

STEP 1

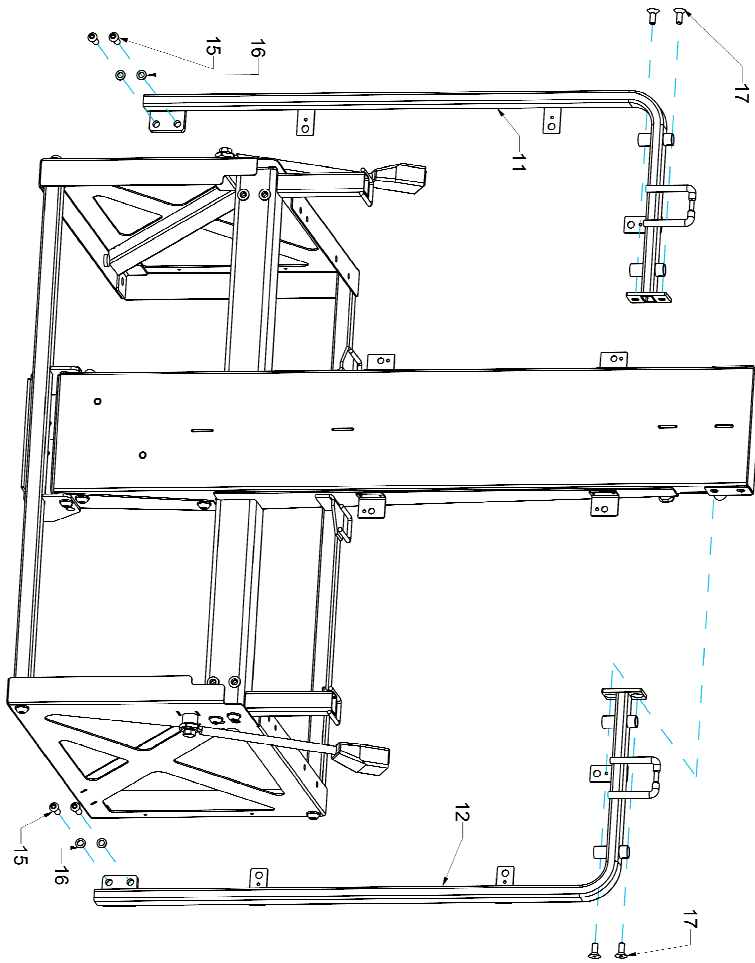

Tightening torque for screws: 23 Nm

FIXATION TO THE ALUMINIUM RAILS

WITHOUT HEIGHT ADJUSTER

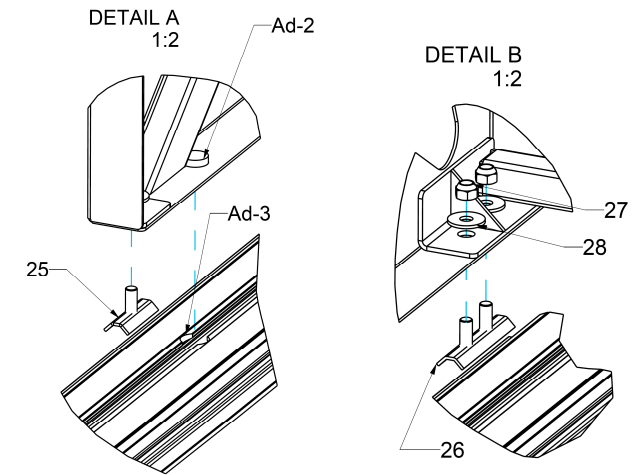
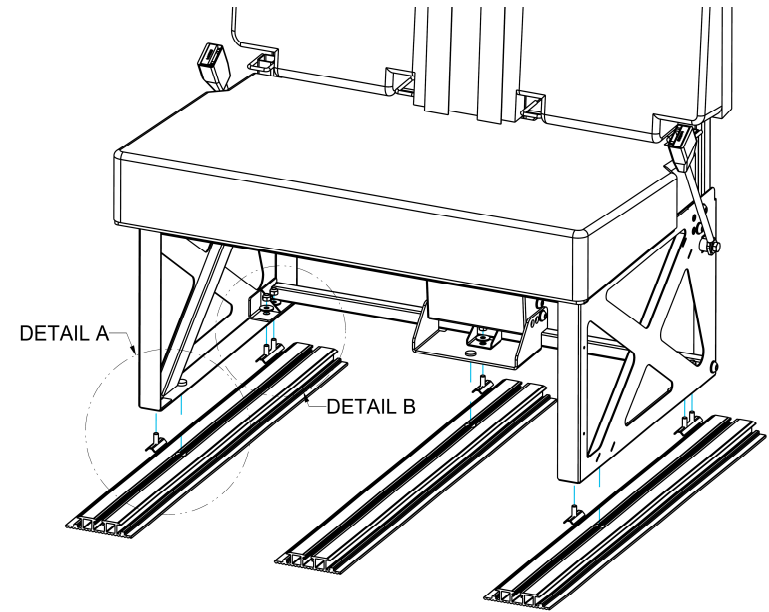

Tightening torque for screws: 27 Nm

Ad-2. Locking pin

Ad-3. Hole for locking pin

STEP 5

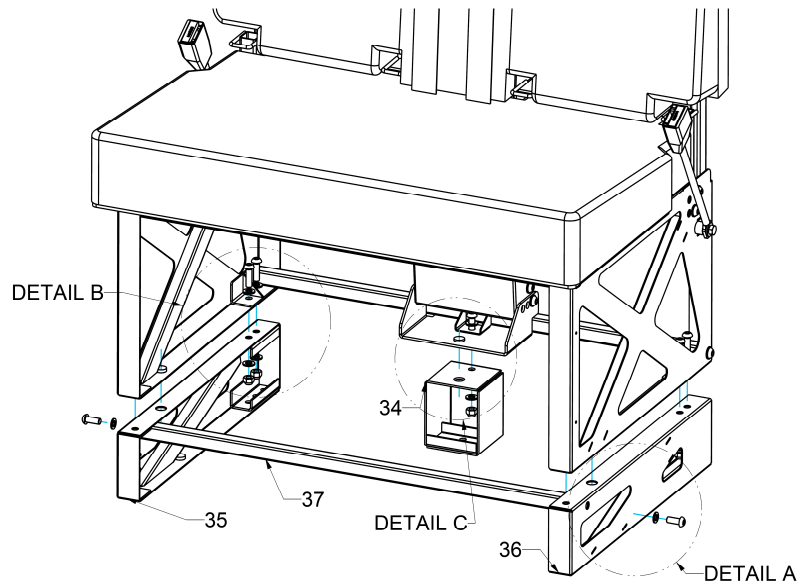

STEP 2

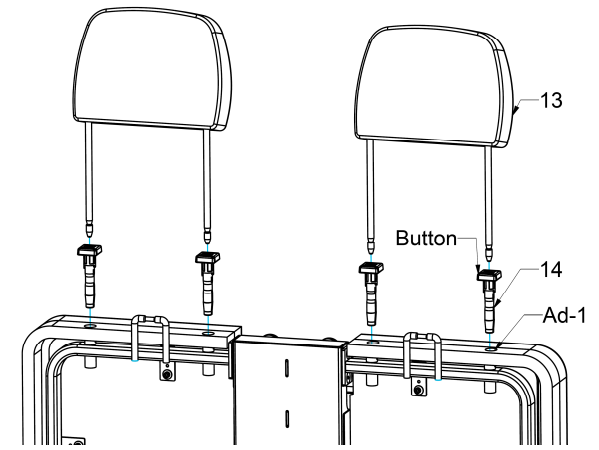

Ad-1. Cut holes for headrest sleeves

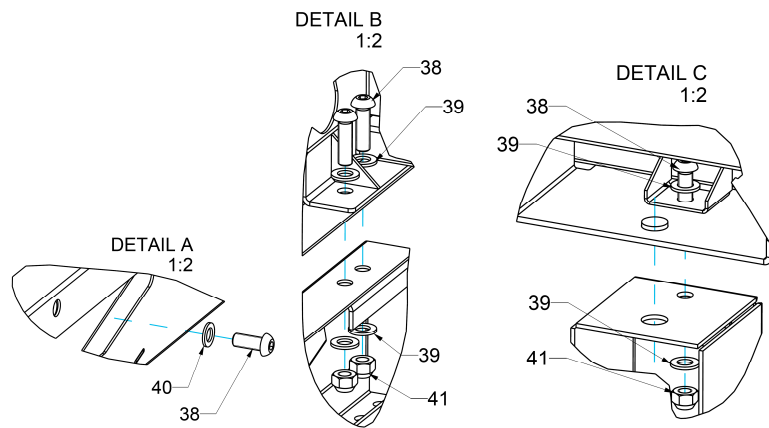
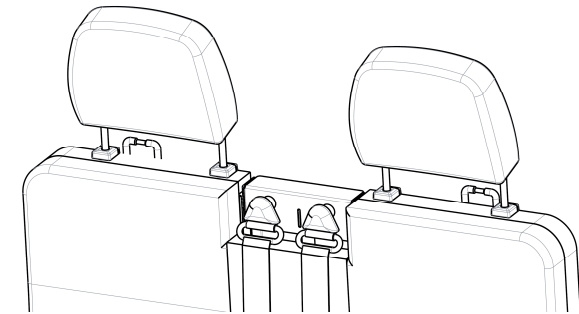

Tightening torque for screws: 65 Nm

STEP 3

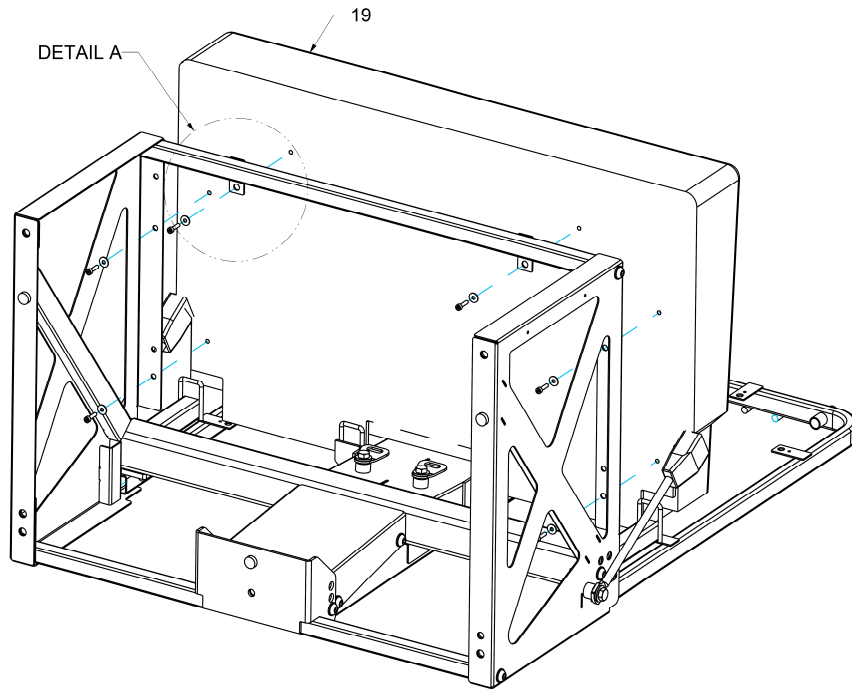

STEP 4

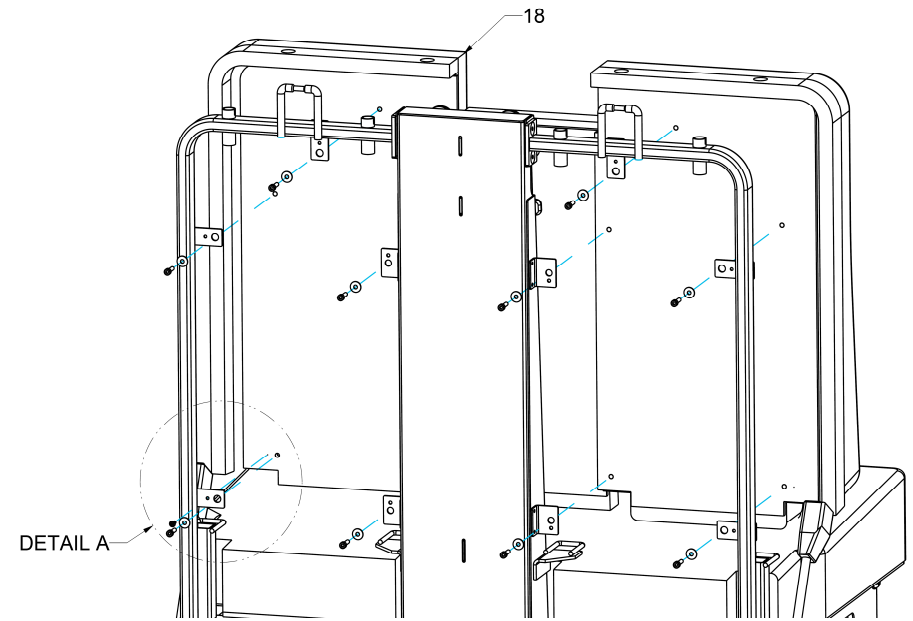

DETAIL A

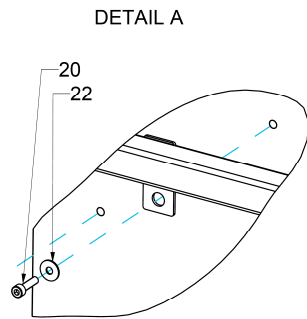

Tightening torque for screws: 5 Nm

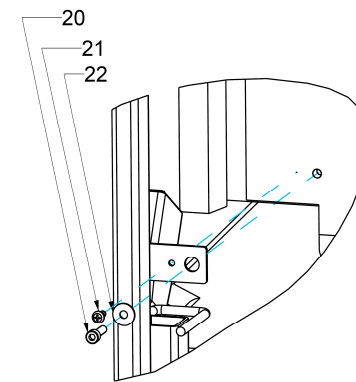

Tightening torque for screws: 5 Nm